

RL20000

S-Beam, Alloy Steel, NTEP Certified 1:5000 III/1:10,000 IIII

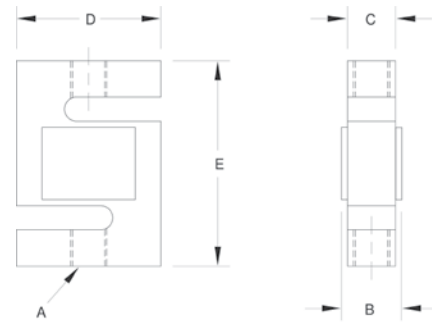

Picture is a representation of actual product



Specifications

Full Scale Output:

3.0mV/V

Output Resistance:

350 (± 3) ohms

Input Resistance:

385 (± 5) ohms

Material/Finish:

High-alloy steel, nickel plated

Temperature:

Compensated range
14° F to 104° F/-10° C to 40° C
Operating range
-40° F to 150° F/-40° C to 65° C

Seal Type:

Environmentally sealed, IP67

Safe Overload:

150% full scale

Rated Excitation:

5-10 VDC (15 V maximum)

Combined Error:

0.02%

Insulation Resistance:

5,000 megohms

Cable Length:

20 ft (6.1 m)

Cable Diameter:

0.200 polyurethane jacket

Cable Color Code:

Red+ Excitation
Black.....- Excitation
Green+ Signal
White- Signal

Warranty:

Two-year limited warranty

Approvals:



Dimensions

RATED CAPACITY	A	B	C	D	E
lb/inches					
25-300	1/4-28 UNF-2B	0.75	0.50	2.00	2.50
500-1,500	1/2-20 UNF-2B	1.00	0.75	2.00	2.50
2,000-2,500	1/2-20 UNF-2B	1.25	1.00	2.00	2.50
3,000	1/2-20 UNF-2B	1.25	1.00	3.00	4.00
5,000-10,000	3/4-16 UNF-2B	1.25	1.00	3.00	4.00
15,000	1-12 UNF-2B	1.50	1.25	4.00	5.50
20,000	1 1/4-12 UNF-2B	2.25	2.00	5.00	7.00
kg/mm					
11.3-136.1	1/4-28 UNF-2B	19.1	12.7	50.8	63.5
226.8-680.4	1/2-20 UNF-2B	25.4	19.1	50.8	63.5
907.2-1,134.0	1/2-20 UNF-2B	31.8	25.4	50.8	63.5
1,360.8	1/2-20 UNF-2B	31.8	25.4	76.2	101.6
2,268.0-4,535.9	3/4-16 UNF-2B	31.8	25.4	76.2	101.6
6,803.9	1-12 UNF-2B	38.1	31.8	101.6	139.7
9,071.9	1 1/4-12 UNF-2B	57.2	50.8	127.0	177.8

RL20000

S-Beam, Alloy Steel, NTEP Certified 1:5000 III/1:10,000 IIIL

Order Information

LOAD RATING		PART #	EST. SHIPPING WEIGHT	PRICE
25 lb	(11.3 kg)	21428	2 lb	\$275.00
50 lb	(22.7 kg)	21429	2 lb	275.00
75 lb	(34.0 kg)	21430	2 lb	275.00
100 lb	(45.4 kg)	21431	2 lb	275.00
150 lb	(68.0 kg)	21432	2 lb	275.00
200 lb	(90.7 kg)	21433	2 lb	275.00
250 lb	(113.4 kg)	21434	2 lb	275.00
300 lb	(136.1 kg)	21435	2 lb	275.00
500 lb	(226.8 kg)	21436	2 lb	275.00
750 lb	(340.2 kg)	21437	2 lb	275.00
1,000 lb	(453.6 kg)	21438	2 lb	275.00
1,500 lb	(680.4 kg)	21439	2 lb	275.00
2,000 lb***	35 ft cable	21356	2 lb	338.00
2,000 lb	(907.2 kg)	21440	2 lb	275.00
2,500 lb	(1,134.0 kg)	21441	2 lb	275.00
3,000 lb	(1,360.8 kg)	21442	4 lb	315.00
5,000 lb***	30 ft cable	17044	4 lb	476.00
5,000 lb	(2,268.0 kg)	21443	4 lb	440.00
10,000 lb	(4,535.9 kg)	21444	4 lb	440.00
15,000 lb	(6,803.9 kg)	21445	7 lb	555.00
20,000 lb***	30 ft cable	17045	17 lb	937.00
20,000 lb	(9,071.9 kg)	21446	17 lb	875.00
Conduit Adapter Kit*(must be factory installed to maintain warranty)				
3/8-24 nipple		31533*	1 lb	30.00
3/8-24 to 1/4-18NPT		31534*	1 lb	30.00
Replacement Agriculture Scale Load Cell - 40 ft Cable				
10,000 lb	(4,535.9 kg)	151746	5 lb	465.00

*PN 1533 and PN 31534 must be installed together to form the Conduit Adapter Kit

***These load cells have 30 ft of cable and trimmed outputs and are used in many batch plants

Interchangeable Products

MANUFACTURER	MODEL
Artech®	20210**

**15,000 lb thread is 1-14 UNF

Weigh Module Available

MANUFACTURER	MODEL	PAGE #
Rice Lake Weighing Systems	ITCM Isolated Tension Cell Mount	46

RL2000SS

S-Beam, Stainless Steel, NTEP Certified 1:10,000 Class III Single Cell



Picture is a representation of actual product

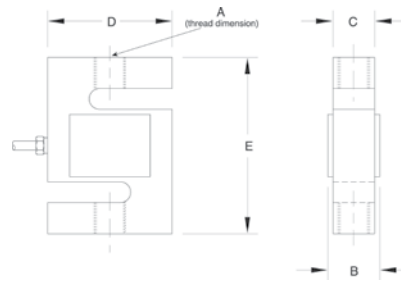

Specifications

Full Scale Output:

3.0 (± 0.008) mV/V

Output Resistance:

350 (± 3.5) ohms

Input Resistance:

390 (± 15) ohms

Material/Finish:

Stainless steel

Temperature:

Compensated range
14° F to 104° F / -10° C to 40° C
Operating range
-40° F to 150° F / -40° C to 65° C

Seal Type:

Environmentally sealed, IP67

Safe Overload:

150% full scale

Rated Excitation:

5-10 VDC (15 V maximum)

Nonlinearity:

0.03% full scale

Hysteresis:

0.02% full scale

Insulation Resistance:

5,000 megohms

Cable Length:

20 ft (6.1 m)

Cable Color Code:

Red+ Excitation
Black.....- Excitation
Green+ Signal
White- Signal

Warranty:

Two-year limited warranty

Approvals:



Dimensions

RATED CAPACITY	A	B	C	D	E
lb/inches					
50-250	1/4-28 UNF-2B	0.65	0.46	2.00	2.40
500-1,000	1/2-20 UNF-2B	0.90	0.71	2.00	2.40
2,500	1/2-20 UNF-2B	1.15	0.96	2.00	2.40
3,000	1/2-20 UNF-2B	1.15	0.96	3.00	3.90
5,000	3/4-16 UNF-2B	1.15	0.96	3.00	3.90
10,000	3/4-16 UNF-2B	1.40	1.21	3.00	3.90
15,000	1-14 UNS-2B	1.63	1.46	3.44	5.50
20,000	1 1/4-12 UNF-2B	1.88	1.68	4.44	7.00
kg/mm					
22.7-113.4	1/4-28 UNF-2B	16.5	11.7	50.8	61.0
226.8-453.6	1/2-20 UNF-2B	22.9	18.0	50.8	61.0
1134.0	1/2-20 UNF-2B	29.2	24.4	50.8	61.0
1360.8	1/2-20 UNF-2B	29.2	24.4	76.2	99.1
2268.0	3/4-16 UNF-2B	29.2	24.4	76.2	99.1
4535.9	3/4-16 UNF-2B	35.7	30.7	76.2	99.1
15,000	1-14 UNS-2B	41.4	37.1	87.4	139.7
20,000	1 1/4-12 UNF-2B	47.8	42.8	112.8	177.8

RL2000SS

Stainless Steel, NTEP Certified 1:10,000 Class III Single Cell

Order Information

LOAD RATING		PART #	EST. SHIPPING WEIGHT	PRICE
RL2000SS NTEP Certified				
100 lb	(45.4 kg)	46511	2 lb	\$295.00
250 lb	(113.4 kg)	46503	2 lb	295.00
500 lb	(226.8 kg)	46504	2 lb	295.00
750 lb	(340.2 kg)	46505	2 lb	295.00
1,000 lb	(453.6 kg)	46506	2 lb	295.00
2,500 lb	(1,134.0 kg)	46507	2 lb	295.00
3,000 lb	(1,360.8 kg)	46508	4 lb	325.00
5,000 lb	(2,268.0 kg)	46509	4 lb	475.00
10,000 lb	(4,535.9 kg)	46510	4 lb	495.00
RL2000SS NON-NTEP Certified				
50 lb	(22.9 kg)	17013	2 lb	295.00
15,000 lb	(6,804.0 kg)	158375	7 lb	675.00
20,000 lb	(9,072.0 kg)	158376	13 lb	895.00
Conduit Adapter Kit*(must be factory installed to maintain warranty)				
3/8-24 nipple		31533*	1 lb	30.00
3/8-24 to 1/4-18 NPT		31534*	1 lb	30.00

* PN 31533 and PN 31534 must be installed together to form the Conduit Adapter Kit

Interchangeable Products

MANUFACTURER	MODEL	PAGE #
VPG Revere®	9363	270
Artech®	SS20210	—

Weigh Module Available

MANUFACTURER	MODEL	PAGE #
Rice Lake Weighing Systems	ITCM Isolated Tension Cell Mount	46

RL2000ST

S-Beam, Stainless Steel, NTEP Certified 1:10,000 Class III Single Cell, IP67



Picture is a representation of actual product

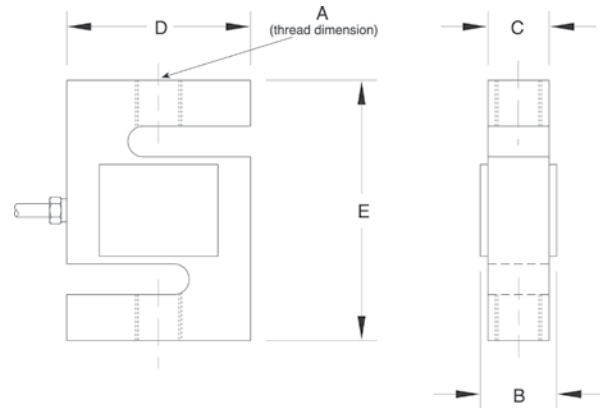

Specifications

Full Scale Output:
3.0 mV/V

Output Resistance:
350 (±3.5) ohms

Input Resistance:
430 (± 60) ohms

Material/Finish:
Stainless steel

Seal Type:
Environmentally sealed, IP67

Safe Overload:
150% full scale

Rated Excitation:
5-10 VDC (15 V maximum)

Nonlinearity:
0.03% full scale

Hysteresis:
0.02% full scale

Insulation Resistance:
5,000 megohms

Temperature:

Compensated range
14° F to 104° F / -10° C to 40° C
Operating range
-40° F to 150° F / -40° C to 65° C

Cable Length:
20 ft (6.1 m)

Cable Diameter:
0.190 polyurethane jacket

Cable Color Code:

Red + Excitation
Black - Excitation
Green + Signal
White - Signal

Warranty:

Two-year limited warranty

Approvals:



Dimensions

RATED CAPACITY	A	B	C	D	E
lb/inches					
50-300	1/4-28 UNF-2B	0.65	0.46	2.00	2.40
500-1,000	1/2-20 UNF-2B	0.90	0.71	2.00	2.40
1,500-2,500	1/2-20 UNF-2B	1.15	.96	2.00	2.40
3,000	1/2-20 UNF-2B	1.15	.96	3.00	3.90
10,000	3/4-16 UNF-2B	1.15	.96	3.00	3.90
kg/mm					
22.7-45.4	1/4-28 UNF-2B	16.5	11.7	50.8	60.9
340.2-453.6	1/2-20 UNF-2B	22.9	18.0	50.8	60.9
680.4-1,134	1/2-20 UNF-2B	29.2	24.4	50.8	60.9
1,360.8	1/2-20 UNF-2B	29.2	24.4	76.2	99.1
2,268.0	3/4-16 UNF-2B	29.2	24.4	76.2	99.1

Order Information

LOAD RATING	PART #	EST. SHIPPING WEIGHT	PRICE
50 lb (22.9 kg)	72741	2 lb	\$295.00
100 lb (45.4 kg)	72742	2 lb	295.00
200 lb (90.72 kg)	72743	2 lb	295.00
250 lb (113.4 kg)	72744	2 lb	295.00
300 lb (136.1 kg)	72745	2 lb	295.00
500 lb (226.8 kg)	72746	2 lb	295.00
750 lb (340.2 kg)	72747	2 lb	295.00
1,000 lb (453.6 kg)	72748	2 lb	295.00
1,500 lb (680.4 kg)	72749	2 lb	295.00
2,000 lb (907.2 kg)	72750	2 lb	295.00
2,500 lb (1,134.0 kg)	72751	2 lb	295.00

Order Information

LOAD RATING	PART #	EST. SHIPPING WEIGHT	PRICE
3,000 lb (1,360.8 kg)	72752	4 lb	\$395.00
5,000 lb (2,268.0 kg)	72753	4 lb	495.00
10,000 lb** (4,535.9 kg)	72754		695.00
15,000 lb** (6,804.0 kg)	72755		995.00
20,000 lb** (9,072.0 kg)	72756		1,295.00
Conduit Adapter Kit* (must be factory installed to maintain warranty)			
3/8-24 nipple	31533*	1 lb	30.00
3/8-24 to 1/4-18 NPT	31534*	1 lb	30.00

*PN 31533 and PN 31534 must be installed together to form the Conduit Adapter Kit.

** Limited quantities available

RL20001



S-Beam, Alloy Steel, NTEP Certified Single Cell, IP67 1:5000 III/1:10,000 IIII

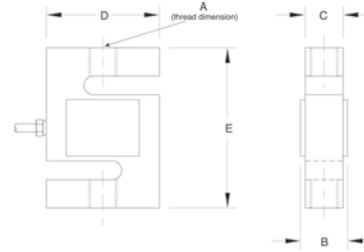

Picture is a representation of actual product



Specifications

<p>Full Scale Output: 3.0mV/V</p> <p>Output Resistance: 350 (± 3) ohms</p> <p>Input Resistance: 385 (± 5) ohms</p> <p>Material/Finish: High-alloy steel, nickel plated</p>	<p>Temperature: Compensated range 14° F to 104° F/-10° C to 40° C Operating range -40° F to 150° F/-40° C to 65° C</p> <p>Seal Type: Environmentally sealed, IP67</p> <p>Safe Overload: 150% full scale</p> <p>Rated Excitation: 5-10 V AC/DC (15 V maximum)</p>	<p>Nonlinearity: 0.03% full scale</p> <p>Hysteresis: 0.02% full scale</p> <p>Insulation Resistance: 5,000 megohms</p> <p>Cable Length: 20 ft (6.1 m)</p> <p>Cable Diameter: 200 polyurethane jacket</p>	<p>Cable Color Code: Red+ Excitation Black.....- Excitation Green+ Signal White- Signal</p> <p>Warranty: Two-year limited warranty</p> <p>Approvals:   </p>
--	--	--	---

Dimensions

RATED CAPACITY	A	B	C	D	E
lb/inches					
250	3/8-24 UNF-2B	0.75	0.50	2.00	3.00
500-2,000	1/2-20 UNF-2B	1.00	0.75	2.00	3.00
2,500-3,000	1/2-20 UNF-2B	1.25	1.00	2.00	3.00
5,000	3/4-16 UNF-2B	1.25	1.00	3.00	4.25
10,000	3/4-16 UNF-2B	1.25	1.00	3.50	4.75
15,000	1-14 UNF-2B	1.50	1.25	4.00	5.50
20,000	1 1/4-12 UNF-2B	2.25	2.00	5.00	7.00
kg/mm					
113.4	3/8-24 UNF-2B	19.1	12.7	50.8	76.2
226.8-907.2	1/2-20 UNF-2B	25.4	19.1	50.8	76.2
1,134.0-1,360.8	1/2-20 UNF-2B	31.8	25.4	50.8	76.2
2,268.0	3/4-16 UNF-2B	31.8	25.4	76.2	108.8
4,535.9	3/4-16 UNF-2B	31.8	25.4	88.9	120.7
6,803.9	1-14 UNF-2B	38.1	31.8	101.6	139.7
9,071.9	1 1/4-12 UNF-2B	57.2	50.8	127.0	177.8

Order Information

LOAD RATING	PART #	EST. SHIPPING WEIGHT	PRICE
250 lb (113.4 kg)	21402	2 lb	\$275.00
500 lb (226.8 kg)	21403	2 lb	275.00
750 lb (340.2 kg)	21404	2 lb	275.00
1,000 lb (453.6 kg)	21405	2 lb	275.00
1,500 lb (680.4 kg)	21406	2 lb	275.00
2,000 lb (907.2 kg)	21407	3 lb	275.00
2,500 lb (1,134.0 kg)	21408	4 lb	275.00
3,000 lb (1,360.8 kg)	21409	3 lb	315.00
5,000 lb (2,268.0 kg)	21410	4 lb	440.00
10,000 lb (4,535.9 kg)	21411	5 lb	440.00
15,000 lb (6,803.9 kg)	21412	7 lb	555.00
20,000 lb (9,071.9 kg)	21413	16 lb	875.00
Conduit Adapter Kit* (must be factory installed to maintain warranty)			
3/8-24 nipple	31533*	1 lb	30.00
3/8-24 to 1/4-18NPT	31534*	1 lb	30.00

*PN 31533 and PN 31534 must be installed together to form the Conduit Adapter Kit

Interchangeable Products

MANUFACTURER	MODEL	PAGE #
VPG Celtron®	STC	198
VPG Scentroid®	60001	303

Weigh Module Available

MANUFACTURER	MODEL	PAGE #
Rice Lake Weighing Systems	ITCM Isolated Tension Cell Mount	46

RL20001HE



S-Beam, Stainless Steel, NTEP Certified 1:5000 Class III/1:10,000 Class III Single Cell Welded-seal, IP68

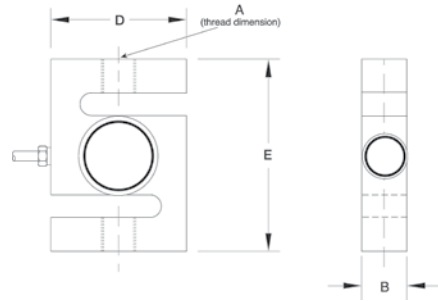

Picture is a representation of actual product



Specifications

<p>Full Scale Output: 2.0 mV/V</p> <p>Bridge Resistance: 350 ohms, nominal</p> <p>Material/Finish: Stainless steel</p> <p>Safe Overload: 150% full scale</p> <p>Rated Excitation: 5-10 VDC (15 V maximum)</p>	<p>Temperature: Compensated range 14° F to 104° F/-10° C to 40° C Operating range -40° F to 150° F/-40° C to 65° C</p> <p>Nonlinearity: 0.03% full scale</p> <p>Hysteresis: 0.02% full scale</p>	<p>Insulation Resistance: 5,000 megohms</p> <p>Seal Type: Welded-seal, IP68</p> <p>Cable Length: 20 ft (6.1 m)</p> <p>Cable Diameter: 0.200 polyurethane jacket</p>	<p>Cable Color Code: Red+ Excitation Black.....- Excitation Green+ Signal White- Signal</p> <p>Warranty: Two-year limited warranty</p> <p>Approvals:   </p>
--	---	---	--

Dimensions

RATED CAPACITY	A	B	D	E
lb/inches				
500-3,000	1/2-20 UNF	1.00	2.00	3.00
5000-10,000	3/4-16 UNF	1.00	3.50	4.75
kg/mm				
453.6-1,360.8	1/2-20	25.4	50.8	76.2
2,268.0-4,535.9	3/4-16	25.4	88.9	120.7

Order Information

LOAD RATING	PART #	EST. SHIPPING WEIGHT	PRICE
RL20001HE NTEP Certified			
500 lb (226.8 kg)	46469	2 lb	\$850.00
750 lb (340.2 kg)	46470	2 lb	850.00
1,000 lb (453.6 kg)	46471	2 lb	850.00
1,500 lb (680.4 kg)	46472	2 lb	850.00
2,000 lb (907.2 kg)	46473	2 lb	850.00
2,500 lb (1,134.0 kg)	46474	2 lb	850.00
3,000 lb (1,360.8 kg)	46475	2 lb	850.00
5,000 lb (2,268.0 kg)	46476	5 lb	1,135.00
RL20001 HE Non-NTEP Certified			
10,000 lb (4,535.9 kg)	36292	5 lb	1,135.00

Interchangeable Products

MANUFACTURER	MODEL	PAGE #
VPG Sensortronics®	60063	305

Weigh Module Available

MANUFACTURER	MODEL	PAGE #
Rice Lake Weighing Systems	ITCM Isolated Tension Cell Mount	46